

## DECEMBER NEWSLETTER

### Visit NUFORM in 2014 at Trade Shows in Pennsylvania, Georgia & California in 2014

Whether you raise poultry, hogs, dairy cattle or just want a superior agricultural building, our cutting edge wall assembly solutions are the smart choice for cost-effective construction and reduced maintenance in the long-run. CONFORM is the ideal building solution for agricultural facilities. CONFORM wall assemblies and the RELINE ceiling liner are a perfect pair for meeting the stringent hygiene levels required in agricultural and food storage facilities. Both products are energy-efficient, and easy to maintain and install.

#### KEY STONE FARM SHOW in York, PA: January 7-9, 2014, Building 2, Booth F

The Keystone Farm Show is the fastest growing farm show on the East Coast for full-time farmers in Pennsylvania, New Jersey, Maryland and Northern Virginia. Since it started, the show has tripled in the number of exhibitors and uses all available space at the York Fairgrounds.

#### International Poultry Expo in Atlanta, GA: January 28-30, B Hall, Booth #6814

The International Poultry Expo is one of the world's premier poultry expositions and is part of the International Production & Processing Expo (IPPE). This year the show is celebrating its 65th anniversary and is the perfect opportunity for you to experience the quality and safety of CONFORM and RELINE.

#### World Agricultural Expo in Tulare, CA: February 11-13, C Hall, Booth #3631

The World Agricultural Expo is the world's largest agricultural expositions. More than 1,400 exhibitors will showcase the latest in farm equipment, communications and technology. Come by our booth to see our products and learn more about Nuform Building Technologies.



Sam Beaini from the Agricultural Sales team looks forward to meeting customers and introducing you to Nuform Building Technologies. CONFORM and RELINE product features will be showcased, and Sam will be happy to answer questions and help you plan your next building project. Take advantage of the opportunity to find out about new products and how they can be used in your dairy parlor, robot room, barn, hog, and poultry facilities. We look forward to seeing you at the tradeshow. Don't hesitate to stop by our booth, call or send us an email for any questions about your agricultural building needs.

### Featured Products: What is CONFORM?

CONFORM is a revolutionary finished stay-in place concrete wall forming system that promotes easy construction in all types of climate, and can be used for load and non-load bearing concrete walls, for above and below grade applications. The system is also versatile enough that it can be used in a wide variety of commercial, industrial, agricultural and institutional facilities.

Forms are available in five different wall types: CF2 (2" concrete wall), CF4 (4" concrete wall), CF6 (6" concrete wall), CF8i (8" concrete wall) and CF\*I (6" concrete wall + 2" of factory injected insulation).

#### The Nuform Advantage: Differences Between CONFORM & ICFs

Technically the CF8i form could be considered an Insulated Concrete Form (ICF), but that's where the similarities end. CONFORM differs in the following ways:

- CONFORM is custom cut in the Nuform factory to the full height of the wall
- CONFORM is very rigid, which minimizes bracing and blowouts
- CONFORM is finished on both sides
- CONFORM is termite proof, and mold and mildew resistant, making it perfect for vehicle wash and agricultural applications
- CONFORM can be panelized into 8' wide sections to minimize on-site labour
- CONFORM has integrated channels for running electrical conduit in the walls
- CONFORM can be used for insulated and non-insulated walls, in any extreme climate, hot or cold



**Food Storage**



**Dairy Parlor**

#### Meet our Staff: Grace Gentile

Grace Gentile is the voice of Nuform Building Technologies Inc; when you call our offices, it's her voice you hear. Grace has been a proud member of the Nuform family for 14 years and is committed to carrying out the company's mission and vision. Grace's primary responsibilities include purchasing supplies, handling account receivables, customer billings and processing payments. Grace loves people and her bright personality ensures all customers have a positive and enjoyable experience, either in person or over the phone. Her positive demeanor, exceptional organization skills and dedication have contributed in making Nuform the company it is today.



#### In This Newsletter

- › Nuform at Keystone Farm Show, January 7-9
- › Nuform at International Poultry Expo, January 8-30
- › Nuform at the World Agricultural Expo, February 11-13, 2014
- › New partnership with Agromatic, the quality agricultural equipment distributor formed

- ★ Products
- 🚚 Applications
- 📄 Technical Info
- 📞 Contact Nuform

#### Featured Product

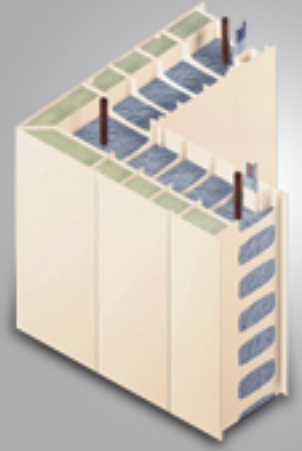

**CONFORM**

The Revolutionary Stay-in-Place Wall Forming System

[Click Here >](#)

#### Projects

Nuform is continuously teaming up with local distributors throughout the US, who are experts in working with builders, farmers and customers. Our strong local connections ensure we can promote, sell and distribute Nuform products such as CONFORM and RELINE to customers throughout their regions. We are excited about the new partnership that has been formed with Agromatic, a quality distributor who reached out to us at the World Dairy Expo in Wisconsin in October 2013.



#### Customer Testimonial

"We milk 200 heads twice daily. Our employees scrub the RELINE after each milking with hot water and a scrub brush - no soap is used. We are extremely happy with the durability and cleanliness of RELINE."

-Elizabeth Grahl, Dinnerbell Farms LLC, RELINE installed April 2011

